

SCOTTY #1100
 DEPTHPOWER 30"
 1995 MODEL
 SHEET 1 OF 2

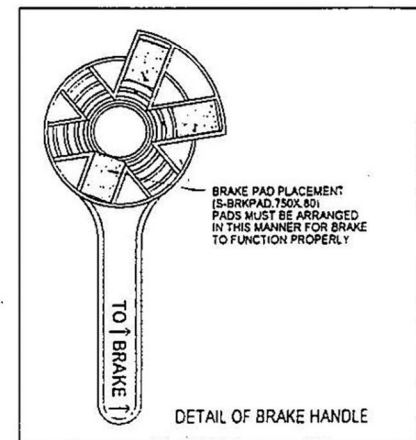

SCOTTY #1100 DEPTHPOWER 30" 1995 MODEL SHEET 2 OF 2

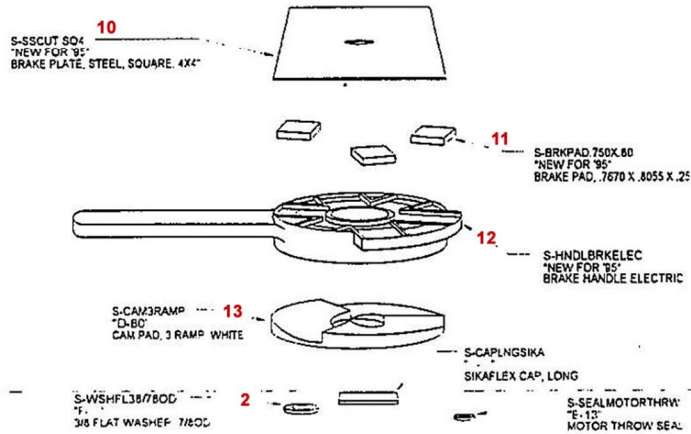
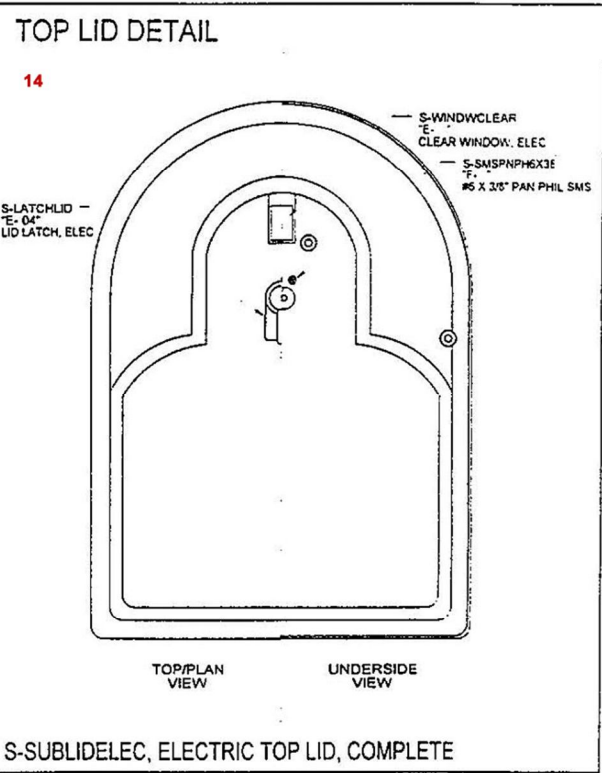
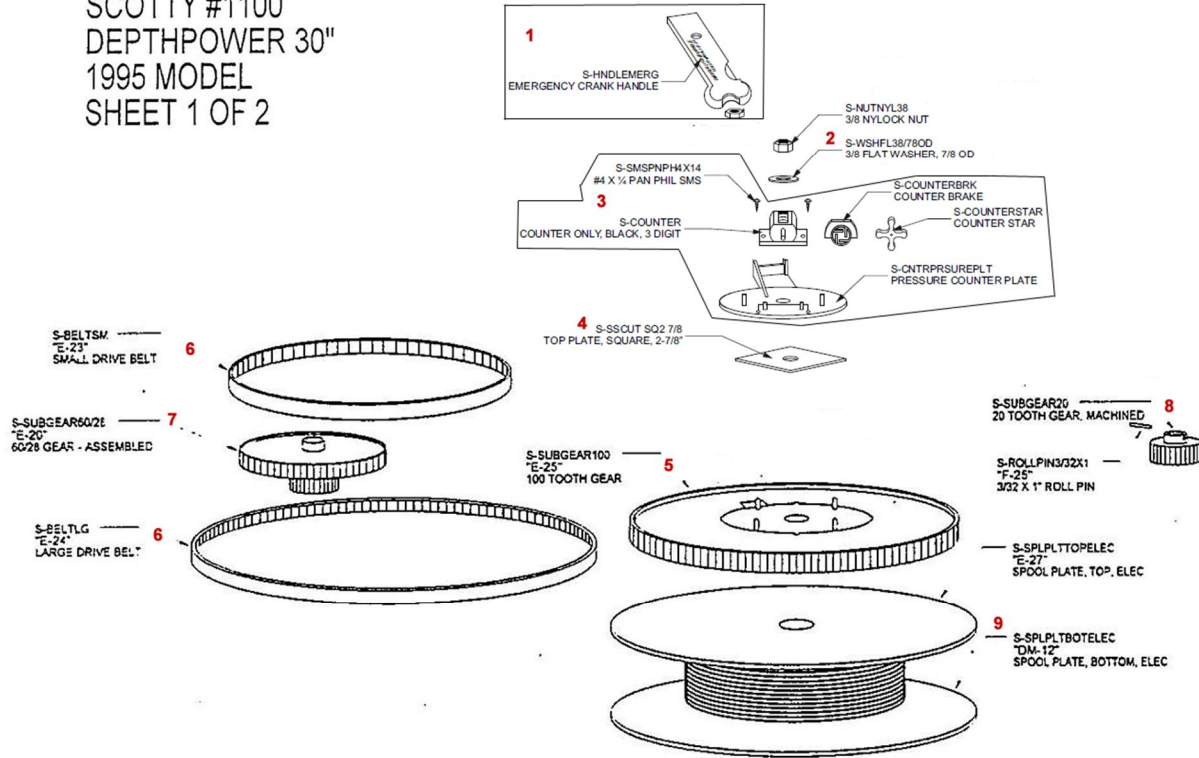
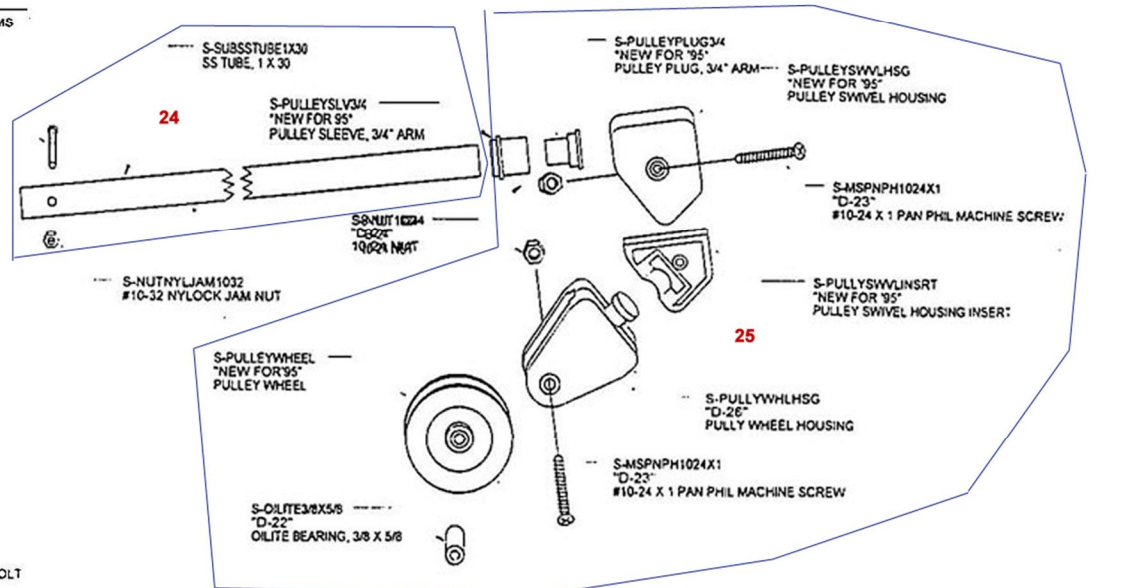
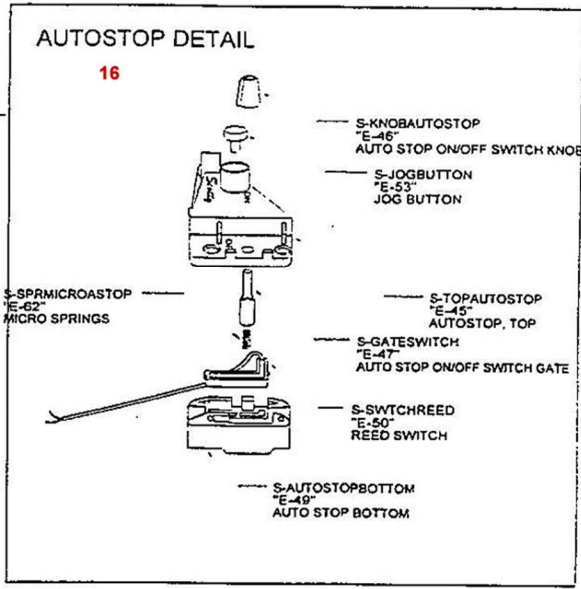
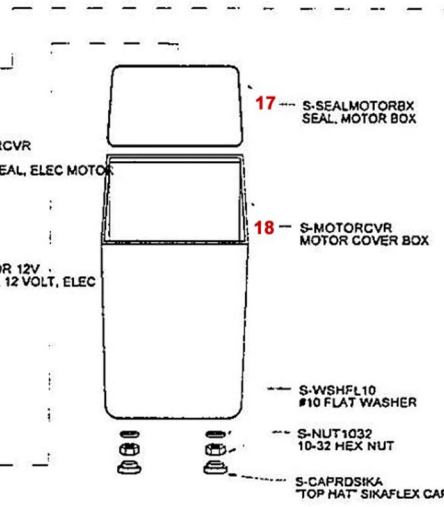
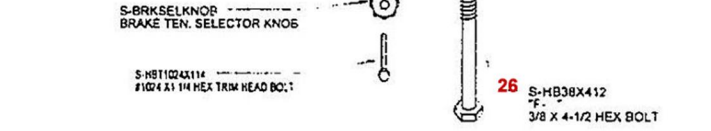
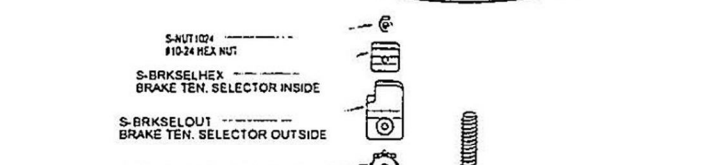
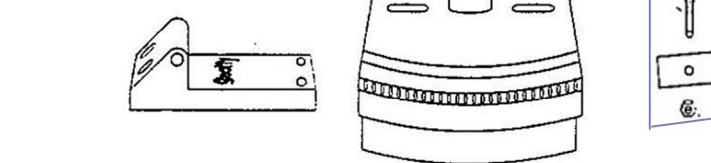
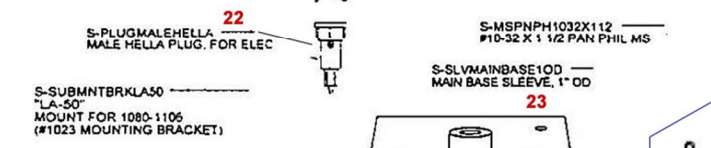
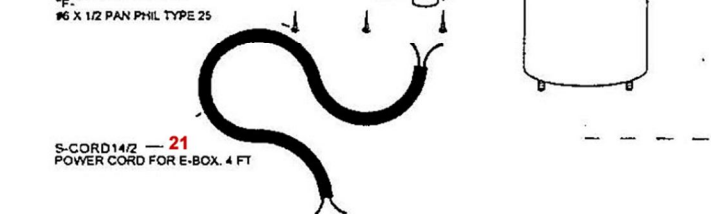
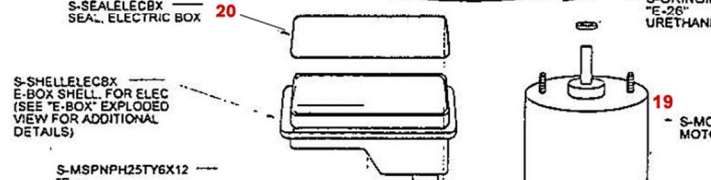
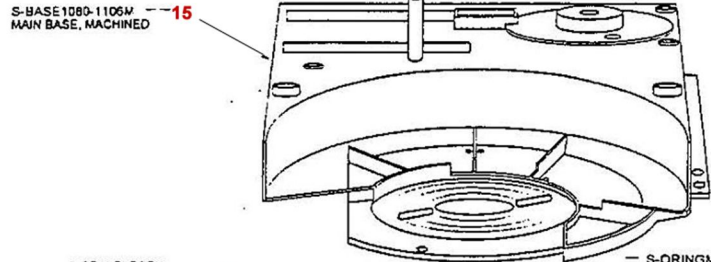

Diagram #	Description	FISH307 Part #	Scotty Part #
1	Emergency Crank Handle	1132	1132
2	38/ Flat Washer, 7/8 OD	24935	S-WSHFL38/78OD
3	Replacement Counter with Base for Electric Downriggers	1145	1145
4	Top Plate Square	24930	S-SSCUTSQ27/8
5	100 Tooth Gear	24932	S-SUBGEAR100
6	Belt Set for Electric Downriggers - for 2000 & Earlier Models	1128	1128
7	Split 60/28 Tooth Gear 2 Belt Unit	24933	S-SUBGEAR60/28
8	20 Tooth Motor Gear, 2 Belt Units	24934	S-SUBGEAR20
9	Spool	24936	S-SPLPLTOPELEC & S-SPLPLBOTELEC
10	Brake Plate, Steel, Square 4"x4"	24863	S-SSCUTSQ4
11	Brake Pad (sold separately , 3 needed)	14145	S-BRKPAD.750X.80
12	Electric Brake Handle	23892	S-HNDLBRKELEC
13	Cam Pad 3 Ramp	20791	S-CAM3RAMP
14	Electric Downrigger Replacement Lid	1131	1131
15	Chassis 2 Belt Unit	24922	S-CHASSISOLD
16	Auto Stop Assembly	40031	
17	Motor Cover Gasket 2 Belt Unit	22919	S-SEALMOTORBX
18	Motor Cover 2 Belt Unit	24925	S-MOTORCVR
19	Motor 12v	22916	S-MOTOR12V-UNI
20	Electrical Box Gasket 2 Belt Unit	22920	S-SEALELECBX
21	Power Cord	22917	S-SUBPOWERCORD
22	Male Hella Plug	1127	1127
23	Old Base Assembly	24035	S-BASE1080-1106 (OLD)
24	30" X 1-1/4" Arm Assembly, 1085, 1100	24967	S-ARM1085/1100
25	Replacement Pulley Kit	1014	1014
26	3/8 x 4-1/2" Hex Bolt	24881	S-HB38X412