

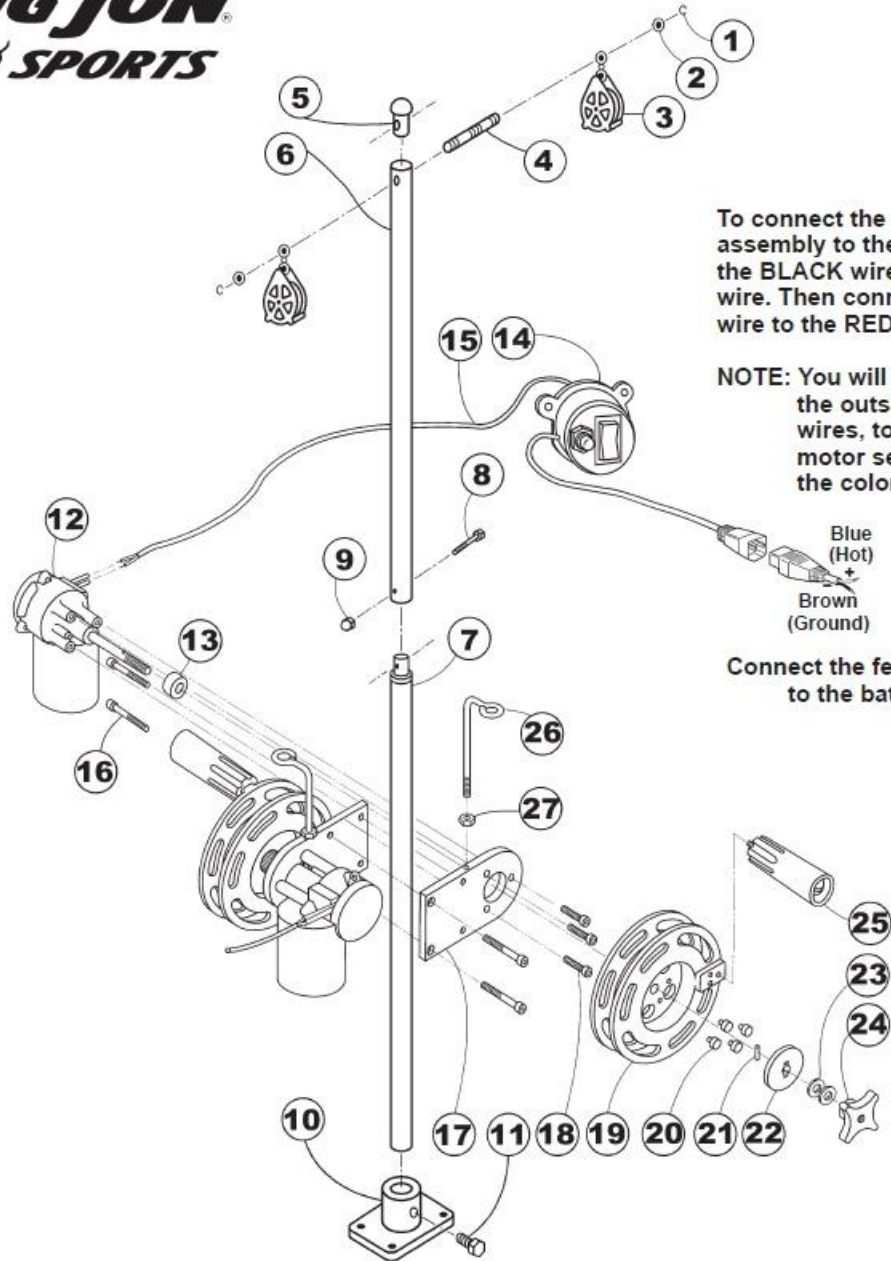

Dual Electric Planer Rigger



To connect the remote switch assembly to the motor; connect the BLACK wire to the BLACK wire. Then connect the WHITE wire to the RED wire.

NOTE: You will have to scrape the outsides of the motor wires, to remove the black motor sealant to identify the color of the motor wires!

Blue (Hot)
+
Brown (Ground)

Connect the female cord to the battery.

Parts List PM00378

Detail No.	Description	Qty.	Order By Part No.
1	Tip Retainer Ring	2	2181
2	Aluminum Tip Retainer	2	5104
3	5 Spoke Tip Assembly	2	BJ3049
4	Top Shaft	1	51280
5	Tube Cap	1	51278
6	Upper Mast Section	1	51281
7	Lower Mast Section	1	51286
8	5/16-18 Bolt	1	2400
9	5/16-18 Acorn Nut	1	2161
10	Mounting Base	1	8046E
11	1/2-20 Hex Bolt	1	8415
12	Motor Assembly	2	2205C
13	Hardened Spacer	2	51059
14	Remote Switch Assembly	2	51145ASM2
15	20 ft. Power Cord	2	2550
16	1/4-20 x 2-1/4 in. SH Cap Screws	4	2145
17	Reel Clamp Plates	2	53000
18	1/4-20 x 1 in. SH Screws	6	2007
19	6 in. Reels	2	51174B
20	Clutch Plugs	8	2244
21	1/8 in. Shaft Pins	2	2163
22	Jr. Clutch Disks	2	51094
23	Belleville Washers	4	2232
24	Jr. Clutch Knobs	2	51153
25	Handle Assembly	2	HA101
26	Guide Eyes	2	2500
27	1/4-2 Hex Nuts	2	2133